

HILLIARD

AURA PENDANT



DESIGN The Aura Pendant is an example of the Glass Tile Collection created by Noel and Janene Hilliard. A cast bronze frame is combined with a woven mosaic of glass tiles. Each tile is beveled soft in a kiln firing, wrapped in copper foil, and soldered over its unique shape, a craftsmanship style that only Hilliard Lamps can achieve.

FINISHES Antique Hammered Bronze and Ivory Glass Tiles, Additional Glass Finishes Available.

HILLIARD

AURA PENDANT

4 SIZES AVAILABLE

DIMENSIONS:	WEIGHT:	LAMPING:
30 DIA x 7 H IN	40 LBS	12 - 40 W
36 DIA x 8 H IN	61 LBS	12 - 40 W
42 DIA x 8 H IN	72 LBS	16 - 40 W
50 DIA x 9 H IN	96 LBS	16 - 40 W
76 DIA x 18 H CM	18 KG	12 - 40 W
92 DIA x 20 H CM	28 KG	12 - 40 W
107 DIA x 20 H CM	33 KG	16 - 40 W
127 DIA x 23 H CM	44 KG	16 - 40 W

CANOPY:	
30 & 36 Dia Lamps:	5.75 DIA x 1.25 W IN
42 Dia Lamp:	7 DIA x 1.25 W IN
50 Dia Lamp:	9 DIA x 1.25 W IN

Drop determined by designer.
Over 48" overall drop includes additional charges.

VOLTAGE: 120v standard

LAMPING: US E12 Candelabra Base Socket.
EU E14
4 Watts, 300 Lumens,
1800-2700 Kelvin Bulbs Included.

UL DAMP LISTED/ CE AVAILABLE

J-BOX REQUIREMENT: 30" (76cm) - **Standard**
36, 42, 50" (92,107,127cm) - **Reinforced**

Each fixture is hand crafted, signed,
and numbered in Arcata, CA

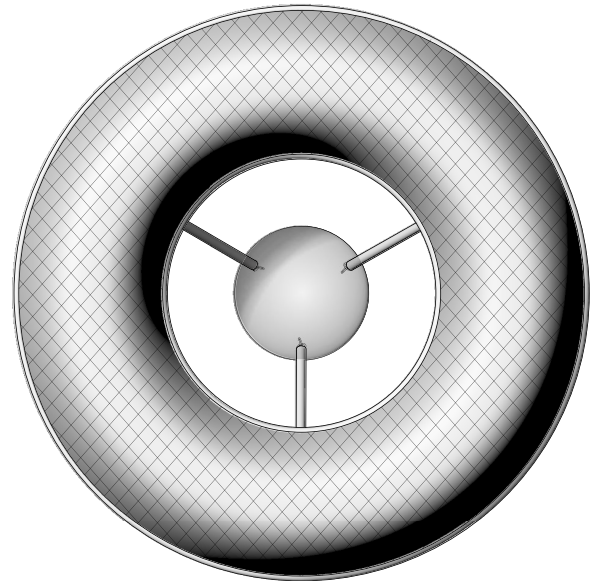
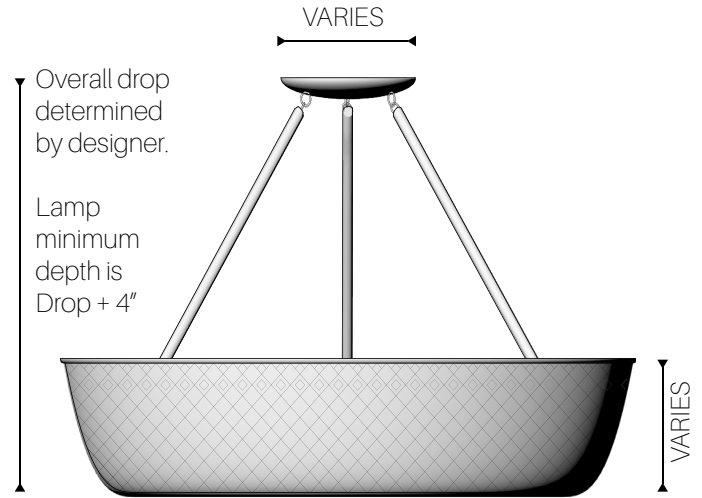

HILLIARD



AURA PENDANT

HILLIARD

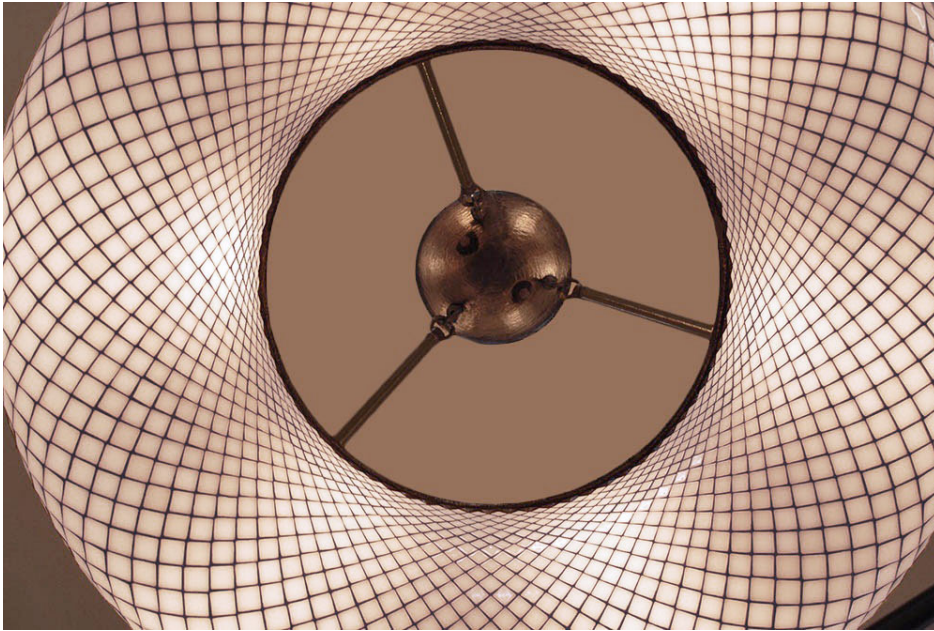

FINISHES SHOWN IN IMAGE:

IVORY GLASS TILE



HAMMERED ANTIQUE
BRONZE

GLASS TILES AVAILABLE IN:
IVORY
LILY WHITE
BLUSH

CONTACT
INFO@HILLIARDLAMPS.COM
FOR CUSTOM REQUESTS